



'down' platform - trains for Bailey Gate, Broadstone, Poole and Bournemouth (West)

Spetisbury Station

- 1860 - opened with a single platform on the Wimborne-Blandford line
- 1901 - double track laid and a second platform and signal box added
- 1934 - downgraded to an unstaffed halt
- 1952 - signal box closed
- 1956 - station closed and buildings demolished soon afterwards
- 1966 - the Somerset & Dorset railway closed to passengers
- 1969 - the Broadstone-Blandford line closed to freight
- 1970 - track lifted
- 2012 - the Spetisbury Station Project began to clear the site



Welcome! Use this plan to explore the station site, but please watch out for uneven platform edging, loose masonry and deep building foundations.

www.spetisburystationproject.wordpress.com

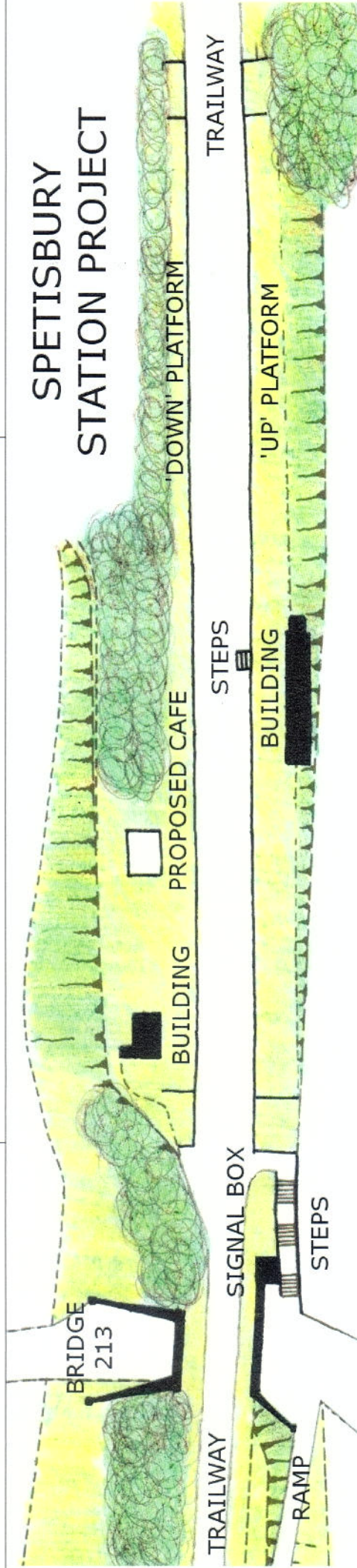

'up' platform - trains for Blandford, Templecombe and Bath (Green Park), also Burnham-on-Sea

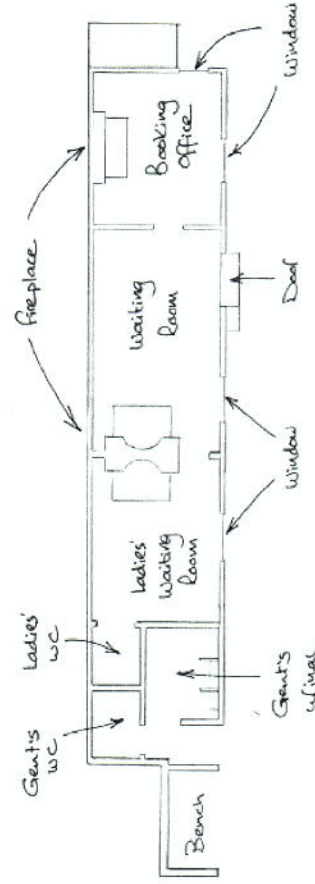

plan of the 'up' platform station building



signal box - operated the crossover points and station signals